



# KPL201

## Electric Pallet Truck 2.0T

- Reliable drive system
- Good durability
- Operation safety assurance
- Easy operation

**L-I-ON**  
TECHNOLOGY

**EP EQUIPMENT CO.,LTD**  
[www.ep-ep.com](http://www.ep-ep.com)



## FEATURE

### Reliable drive system

The KPL201 offers great performance and operation stability due to its reliable drive system with a driving speed of 10km/h and precise controlling.



### Good durability

The KPL201 adopts high strength vertical gear box to extend its working life.



### Operation safety assurance

The KPL201 protective steel supports ensure operation safety even at a high speed and includes an automatic speed decreasing function when steering.



### Easy operation

The easy-triggered pedal provides KPL201 with great driving comfort. It offers good visibility for the operator to lean in against the protective steel shell.

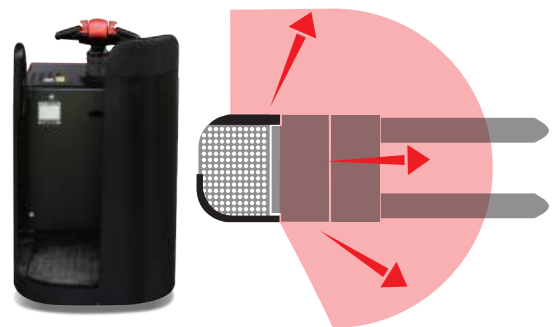

# Electric Pallet Truck 2.0T

## KPL201

Distinguishing mark				
1.1	Manufacturer			EP
1.2	Model designation			KPL201
1.3	Drive unit			Electrics
1.4	Operator type			standing
1.5	rated capacity	Q	kg	2000
1.6	Load center distance	c	mm	600
1.8	Load distance	x	mm	977
1.9	Wheelbase	y	mm	1529
Weight				
2.1	Service weight (include battery)		kg	760
2.2	Axle loading, laden driving side/loading side		kg	980 / 1780
2.3	Axle loading, unladen driving side/loading side		kg	610 / 150
Types, Chassis				
3.1	Tyre type driving wheels/loading wheels			PU / PU
3.2	Tyre size, driving wheels (diameter×width)		mm	Φ230x75
3.3	Tyre size, loading wheels (diameter×width)		mm	2x Φ85x70
3.4	Tyre size, caster wheels (diameter×width)		mm	Φ130x60
3.5	Wheels, number driving, caster/loading (x=drive wheels)		mm	1 x +2 / 4
3.6	Track width, front, driving side	b10	mm	514
3.7	Track width, rear, loading side	b11	mm	370 / 515
Dimensions				
4.4	Lift height	h3	mm	125
4.9	Height drawbar in driving position min./max.	h14	mm	1154/1254
4.15	Lowered height	h13	mm	85
4.19	Overall length	l1	mm	2381
4.20	Length to face of forks	l2	mm	1234
4.21	Overall width	b1/ b2	mm	734 / -
4.22	Fork dimensions	s/ e/ l	mm	55 x 170 x 1150
4.25	Distance between fork-arms	b5	mm	540 / 685
4.32	Ground clearance, center of wheelbase	m2	mm	35
4.34.1	Aisle width for pallets 1000 × 1200 crossways	Ast	mm	3017
4.34.2	Aisle width for pallets 800 × 1200 lengthways	Ast	mm	2874
4.35	Turning radius	Wa	mm	2217
Performance data				
5.1	Travel speed, laden/ unladen	km/ h	km/h	8.5 / 10.0
5.2	Lifting speed, laden/ unladen		m/ s	0.051 / 0.060
5.3	Lowering speed, laden/ unladen		m/ s	0.032 / 0.039
5.8	Max. gradeability, laden/unladen		%	6 / 16
5.10	Service brake type			Electromagnetic
Electric-engine				
6.1	Drive motor rating S2 60 min		kW	1.6
6.2	Lift motor rating at S3 15%		kW	2.2
6.3	The maximum allowed size battery		mm	652 x 270 x 680
6.4	Battery voltage/nominal capacity K5		V/ Ah	24 / 210
6.5	Battery weight		kg	70
Addition data				
8.1	Type of drive control			AC
10.5	Steering type			electric
10.7	Sound pressure level at the driver's ear		dB (A)	74

If there are improvements of technical parameters or configurations, no further notice will be given.  
The diagram shown may contain non-standard configurations.

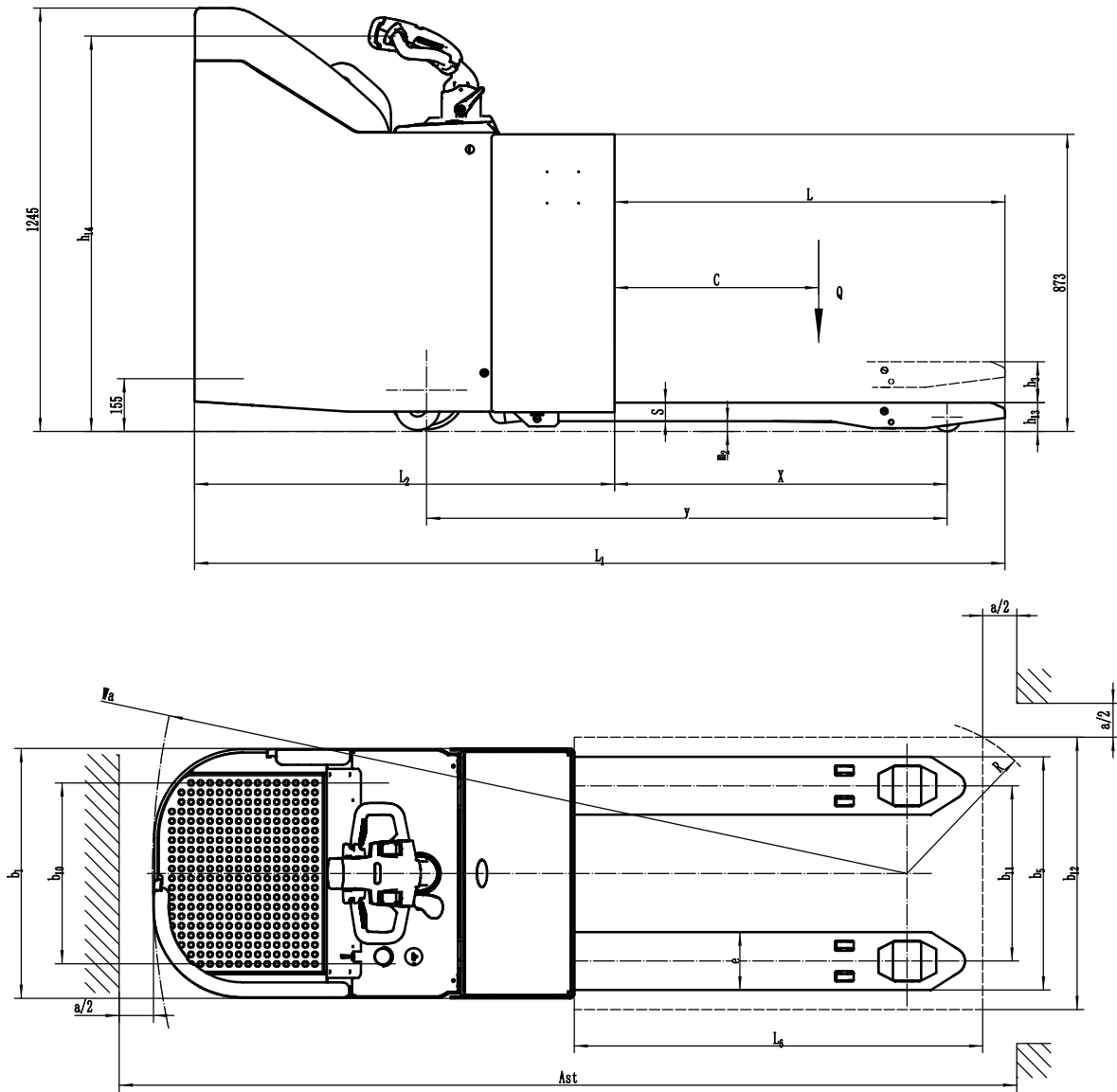

## Option

Optional items	KPL201
1 Fork length*width	●1150*685 ○1150/1220*540 ○1220*685
2 load wheel	●double ○single
3 Driving wheel	●PU
4 Caster wheel	●
5 Battery indicator with hour meter	●
6 Battery capacity	○280AH (lead-acid) ○345AH (lead-acid) ●210AH (li-ion)
7 Lateral change battery	○
8 half speed function in turning	●
9 Fork lowered height	●85mm
10 Special backrest	○48in○60in

Note: ● standard ○ option — NA