



EPL151

Electric Pallet Truck 1.5T **LI-ION** TECHNOLOGY

- New plug-in lithium battery pallet truck;
- Ultimate small size;
- Frame metal forming with high-duty structure.

EP EQUIPMENT CO.,LTD
www.ep-ep.com



Electric Pallet Truck 1.5T

EPL151

Distinguishing mark				
1.1	Manufacturer			EP
1.2	Model designation			EPL151
1.3	Drive unit			Battery
1.4	Operator type			pedestrian
1.5	rated capacity	Q	kg	1500
1.6	Load center distance	c	mm	600
1.8	Load distance	x	mm	883/946
1.9	Wheelbase	y	mm	1105/1168
Weight				
2.1	Service weight (include battery)		kg	165
2.2	Axle loading, laden driving side/loading side		kg	574/1096
2.3	Axle loading, unladen driving side/loading side		kg	130/40
Types, Chassis				
3.1	Tyre type driving wheels/loading wheels			PU/ PU
3.2	Tyre size, driving wheels (diameter×width)		mm	Φ210×70
3.3	Tyre size, loading wheels (diameter×width)		mm	2x Φ78×60(Φ78×88)
3.4	Tyre size, caster wheels (diameter×width)		mm	Φ74×48
3.5	Wheels, number driving, caster/loading (x=drive wheels)		mm	1x 2/4 (1x 2/2)
3.6	Track width, front, driving side	b10	mm	438
3.7	Track width, rear, loading side	b11	mm	390
Dimensions				
4.4	Lift height	h3	mm	115
4.9	Height drawbar in driving position min./max.	h14	mm	700/1170
4.15	Lowered height	h13	mm	80
4.19	Overall length	l1	mm	1525
4.20	Length to face of forks	l2	mm	375
4.21	Overall width	b1/ b2	mm	600
4.22	Fork dimensions	s/ e/ l	mm	50/150/1150
4.25	Distance between fork-arms	b5	mm	540/685
4.32	Ground clearance, center of wheelbase	m2	mm	30
4.34.1	Aisle width for pallets 1000 × 1200 crossways	Ast	mm	2091
4.34.2	Aisle width for pallets 800 × 1200 lengthways	Ast	mm	2148
4.35	Turning radius	Wa	mm	1330
Performance data				
5.1	Travel speed, laden/ unladen	km/ h	km/h	4/4.5
5.2	Lifting speed, laden/ unladen		m/ s	0.017/0.022
5.3	Lowering speed, laden/ unladen		m/ s	0.044/0.021
5.8	Max. gradeability, laden/unladen		%	5/16
5.10	Service brake type			Electromagnetic
Electric-engine				
6.1	Drive motor rating S2 60 min		kW	0.65
6.2	Lift motor rating at S3 15%		kW	0.8
6.3	The maximum allowed size battery		mm	175*124*407 (li-ion)
6.4	Battery voltage/nominal capacity K20		V/ Ah	24V*/140Ah
6.5	Battery weight		kg	13*1
Addition data				
8.1	Type of drive control			DC
10.5	Steering type			Mechanical
10.7	Sound pressure level at the driver's ear		dB (A)	74

If there are improvements of technical parameters or configurations, no further notice will be given.
The diagram shown may contain non-standard configurations.

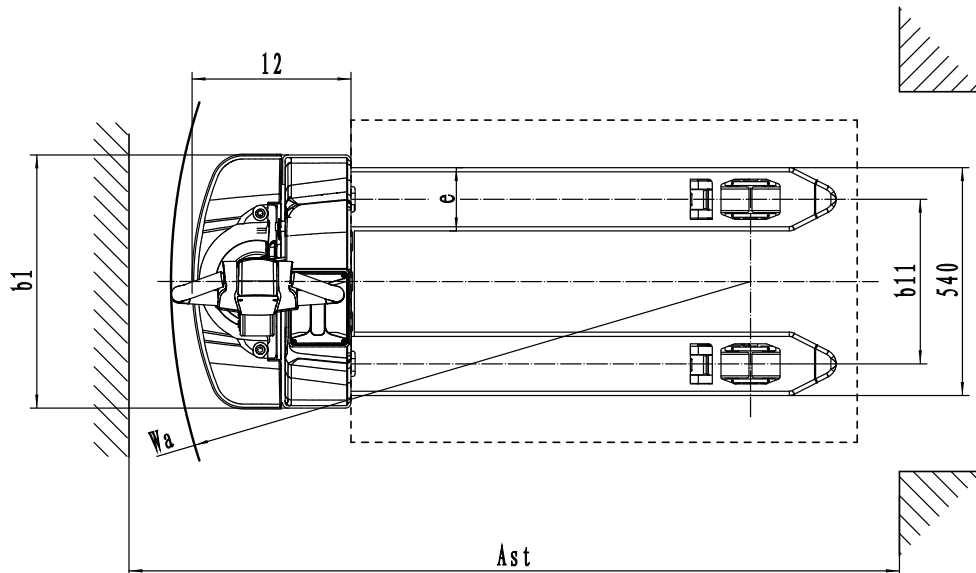
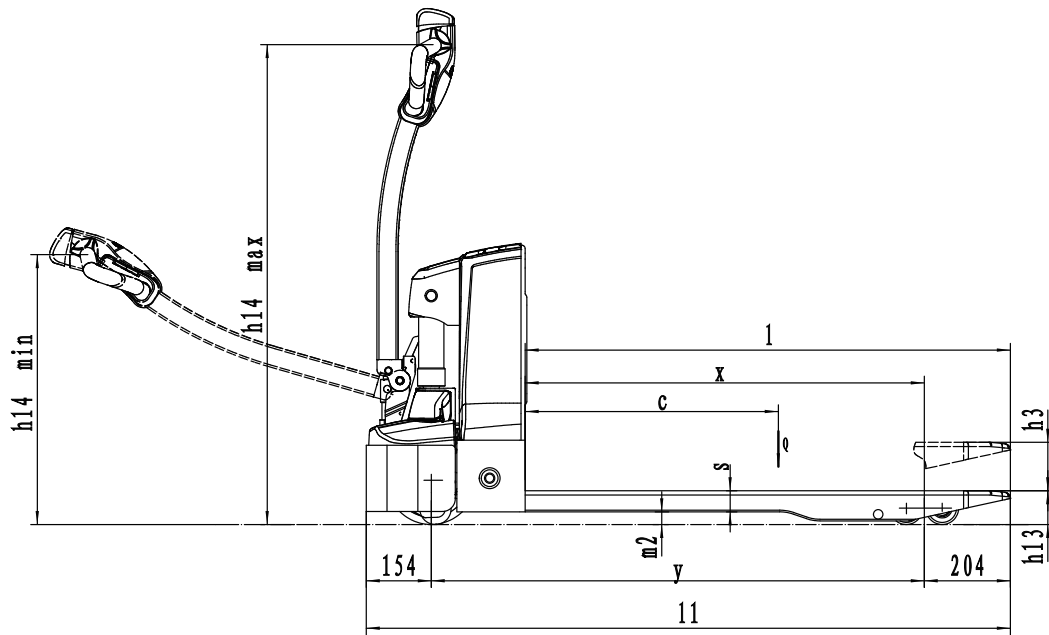

Option

Optional items	EPL151
Fork length	○700/800/915/1000/1070/1100/1150/1300
Fork width	○685
Single load wheel	○
Driving wheel	○PU wheel with Pattern
Balance wheel	●
Battery capacity40AH	●
Lithium external charger 24V20A	●
Vertical handler working	○
In and out of the tray guide wheel	○
Special backrest	○1220mm (48in) /1520mm (60in)
Note: Fork length < 1400, capacity1.5T; Fork length≥1400, capacity1.0T	
Note: ● standard ○ option — NA	